

SMOKE CONTAINMENT CAVITY BARRIERS

(IDEAL FOR HOSPITALS AND NURSING HOMES)



**Supplied in rolls for
easy carrying through
manholes**

GENERAL

For health care and aged care classes of buildings, (BCA Class 9a and 9c), the Building Code of Australia requires the use of smoke walls for containment of smoke within discrete smoke zones.

Audits of many of these facilities results in non compliances where the required smoke walls do not extend to the underside of either the floor above or the non combustible roof covering. These non conformances are hidden in most cases by a non-rated suspended ceiling.

Smoke Control has developed and tested a new flexible smoke containment cavity barrier system, called SMOKEHALT, designed to allow cost effective and practical upgrade of smoke walls within the cavities above non-rated suspended ceilings.

The SMOKEHALT system consists of a innovative and flexible fabric membrane, fixed to either timber or steel stud work systems, installed within the cavity barrier.

The SMOKEHALT system has been developed to allow the materials to be passed up into the roof cavity through a standard manhole and for the upgrade works to be conducted within the cavity with semi-skilled labour.

Smoke Control also supply a full range of fire resistance cavity barrier systems, including ORBIT FR, FLAMESEAL FS, FLAMESEAL 60/30 and FLAMESEAL PLUS. Please contact us for details.

KEY FEATURES

- Flexible fabric smoke barrier.
- 200°C for 30 minutes.
- Practical & Economical.
- Lightweight.
- Designed for limited space installations.
- Installation using standard tools.
- Complete DIY instructions available.
- Ideal for class 9a & 9c buildings.

SMOKEHALT

FIRE & SMOKE CONTAINMENT CAVITY BARRIERS

(IDEAL FOR HOSPITALS AND NURSING HOMES)



Description

SMOKEHALT is grey in colour. It is user friendly, flexible, durable and easy to manipulate and cut to shape.

Installation

Complete Do-It-Yourself (DIY) installation instructions are available. Alternatively, Smoke Control can provide customers with supply and installation through our fully trained and approved installer network Australia wide.

Maintenance

While this passive system is virtually maintenance free, an annual survey is required (as is for all essential service systems) under the new edition of AS1851-2005. Trades installing additional services that are to penetrate the barrier after its installation should contact our offices for our DIY instructions.

Sizes

SMOKEHALT is supplied in rolls of:

- a) 1000mm wide x 50m long
- b) 1000mm wide and cut to any length

Project Specification

"Extend all smoke walls to the under side of the roof with SMOKEHALT by Smoke Control (ph: 02 9748 4384) or approved equivalent. The system shall provide proven resistance to smoke at 200°C for 30 minutes."

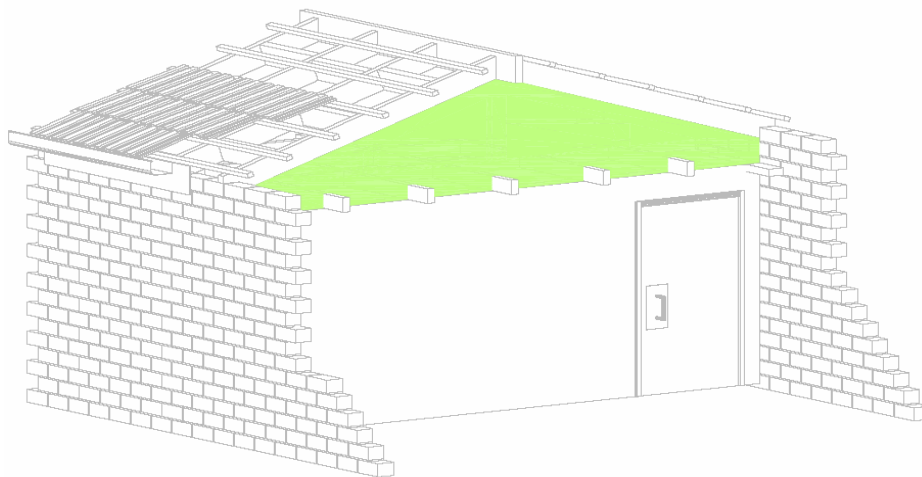
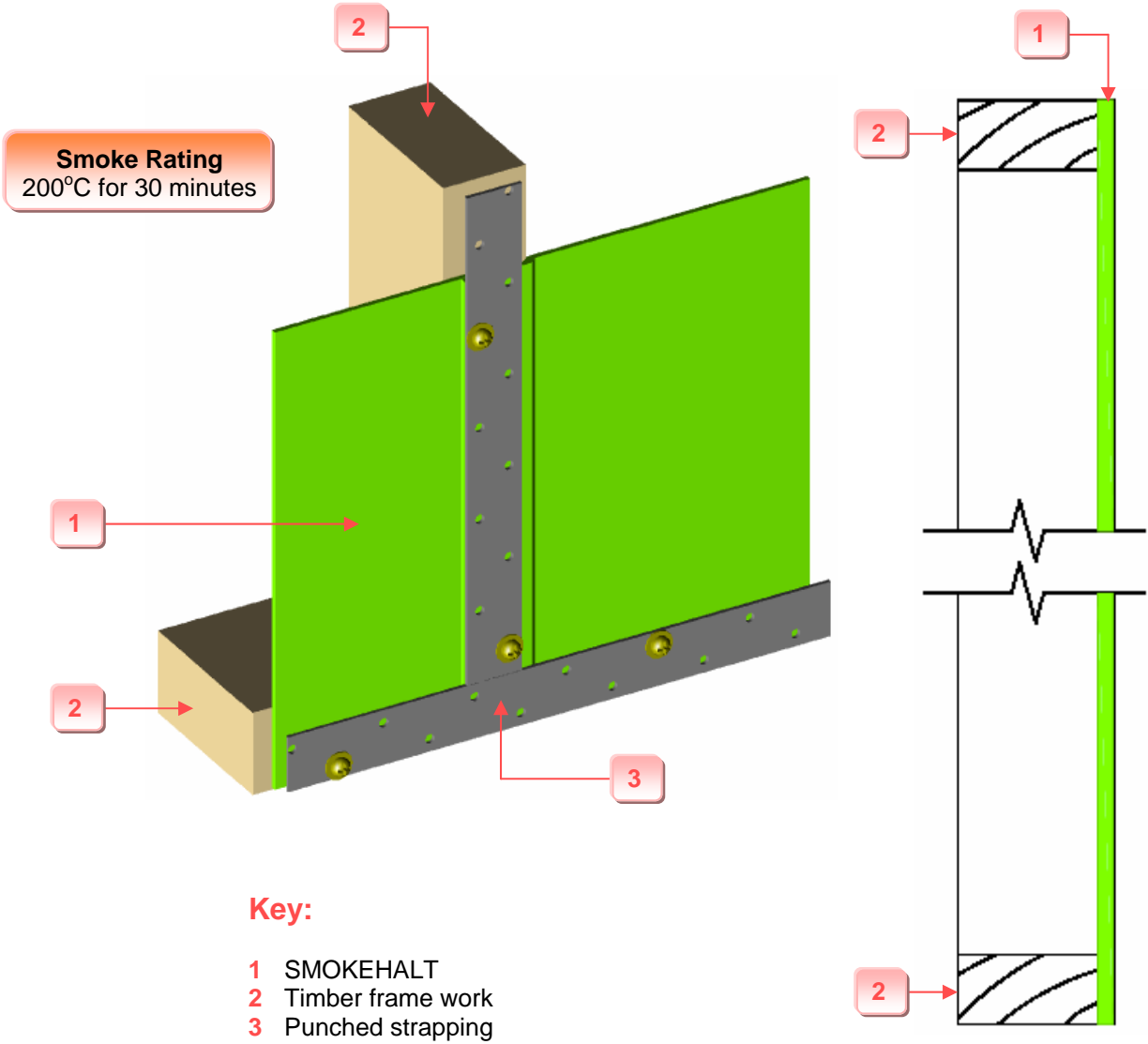

Figure 1: Typical SMOKEHALT Installation

Information given in this publication is given to the best of our knowledge and in good faith. Smoke Control is not responsible if recipients of test reports, assessments or literature misinterpret the contents and wrongly use products based on those misinterpretations. No liability is accepted for error omissions in this document. Smoke Control reserves the right to change specification without notice.

SMOKEHALT

Roof Cavity Barrier Systems
(fixed to one side only)



SMOKEHALT	Fix to one side only
Stud work	90 x 45 pine studs
Vertical stud spacing	Nominal 950mm centres (maximum) or 800mm centres with any service penetration.
Fixings	Using punched strapping (Carlray or equivalent) with self tapping screws @ 200mm centres.

* For more detailed installation details, contact Smoke Control.

SMOKEHALT