



# Smokeglaze Frameless Glazing System

**CERTIFIED AS -/30/-**

Specially developed for Fire Engineers and Architects to be used in lieu of sprinklers on toughened glass, this cost effective, fire resistant safety glass system requires no permanent water storage or hob wall.

## Advantages:

- Virtually maintenance free
- No water storage required
- A range of decorative glass finishes available
- Full floor to ceiling glass system unlike sprinklered toughened glass systems
- Available with frameless glass door
- 30 minutes fire integrity and smoke containment (including the frameless glass door)
- Clear, break resistant Class A safety glass
- Perimeter framing consists of a slimline steel profile which can be powder coated in any colour or concealed into the building fabric
- Framing system manufactured locally for prompt reliable service

## SMOKEGLAZE FRAMELESS GLAZING SYSTEM CERTIFIED AS -/30/-

### System design

The system consists of a slimline perimeter profile (50 x 40mm nominal) that may be concealed above ceilings and below floor levels if required. Corner posts are required to maintain the fire rating. The glass is butt jointed using a narrow (21mm wide nominal) stainless steel H section. Corners require 50 x 50mm posts.

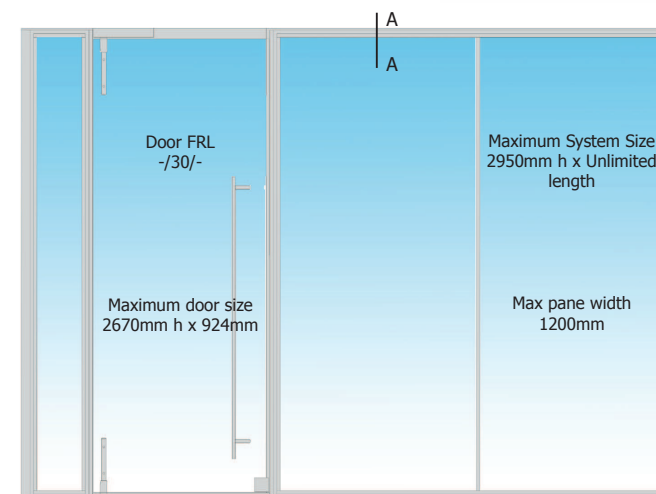

Typical Section AA

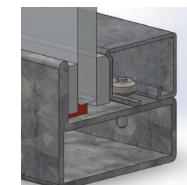

### Hardware and Gasketing

Our Smokeglaze frameless glazed doors require fire tested and approved floor or transom mounted pivots. Stainless steel pull handles can be mounted to the door provided the hole cut out sizes do not exceed a maximum of two holes at 30mm diameter (including countersink) and are located no less than 100mm from any edge.

Approved smoke seal gaskets are supplied standard on 3 sides of each door. Standard glazing gaskets are black. Approved black rubber gaskets are an optional extra. Magnetic hold open and magnetic lock options are also available, contact us for details.

### How to Specify

The glazing system shall be Smoke Control's (1300 665 471) proprietary Smokeglaze frameless glazing system fire tested for up to FRL -/30/-, incorporating clear fire resistant safety glass and frameless glass door(s) with the hardware nominated in the hardware schedule. The system shall incorporate an approved black gasket and be designed and installed to comply with human impact requirements.

### You may also like...

For deemed-to-satisfy frameless systems with up to 2 hour fire ratings please refer to our Clearline frameless EI range on the following pages

### For More Information

Contact Smoke Control on T: 1300 665 471 or visit our website at [www.smokecontrol.com.au](http://www.smokecontrol.com.au)

### Smokeglaze

$U_v = 5.5$

$L_t = 87\%$

$R_w = 37dB^*$

FRL = -/30/-

Saf = CLASS A

CE