

SECO Ni 24 40

STROKE 0-600, 601-900mm



CHAIN ACTUATOR / 24V dc / 400N

The SECO Ni 24 40 24V dc window actuator is a certified and compliant chain actuator designed to provide precise and reliable operation for smoke and environmental ventilation applications.

- The SECO Ni 24 40 has a range of stroke lengths and provides an automatic switch off when the end position is reached.
- The closing of the actuator has been electronically defined via the pressing force to provide a tight close on every operation.
- Compact design with standard or tailored finishes and flex lengths.
- Extensive range of bracketry to suit all window system applications.

ASSOCIATED CONTROLS

STROKE 0-600mm		STROKE 601-900mm	
CONTROLLER	No. ACTUATORS*	CONTROLLER	No. ACTUATORS*
3 AMP Transformer	3	3 AMP Transformer	2
NVLogiQ PSU	4	NVLogiQ PSU	4
SHEVTEC Controller	8	SHEVTEC Controller	6
30 AMP PSU	30	30 AMP PSU	25
OS2 AC Controller	N/A	OS2 AC Controller	N/A

*Recommended maximum no. of actuators

NB: 24V actuators require control from a compatible low voltage unit such as an OS2 SHEVTEC controller or NVLogiQ® PSU and permanent power should not be applied.

ORIENTATION

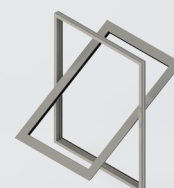
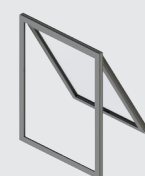

APPLICATIONS



Smoke Ventilation



Environmental Ventilation

ACCREDITATIONS



Certified & tested in accordance with EN12101-2

SECO Ni 24 40 CHAIN ACTUATOR / 24V dc / 400N

TECHNICAL DRAWING

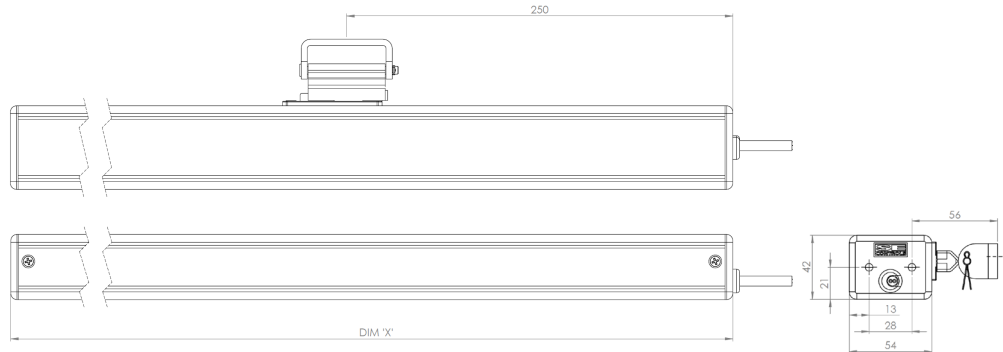

DIMENSIONS

DIM X (mm)	STROKE (mm)
635	up to 600
785	601-900

STANDARD BRACKET DETAIL

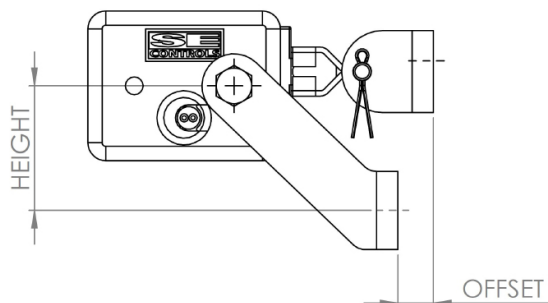

BRACKET PRODUCT CODES

Offset (mm)	0	5	8	10	15	20
Height (mm)						
35	AKS16000001	AKS16050001	AKS16080001	AKS16100001	AKS16150001	N/A
40	AKS16000002	AKS16050002	AKS16080002	AKS16100002	AKS16150002	N/A
50	AKS16000003	AKS16050003	AKS16080003	AKS16100003	AKS16150003	AKS16200003

PRODUCT CODES

SILVER GREY (RAL 9006)	OPERATING VOLTAGE	FORCE	STROKE
AASI400600S	24V	400N	600mm
AASI400900S	24V	400N	900mm

TECHNICAL DATA

ACTUATOR	SECO Ni 24 40
ACTUATOR TYPE	24V dc Chain Opener
VOLTAGE (all +/-5%)	24V dc
CURRENT DRAW (Amp)	0-600mm= 1.0A 601-900mm= 1.2A
STROKE	0-600mm (configurable) 601-900mm (configurable)*
OPERATING SPEED	15mm/sec (configurable)
AMBIENT OPERATING TEMP	-5°C to +60°C
THRUST FORCE	400N
CLOSE FORCE	400N
SOFT CLOSE	Yes
SWITCHING	Electronic
STANDARD FINISH	Powder coated Grey (RAL 9006)
SEAL RELIEF	Programmable up to 20mm
CLAMPING FORCE	4000N
COLOUR OPTION	Other RAL colours available on request
FLEX LENGTH	2m
FLEX TYPE	2 core/ 0.75mm silicone 4 core (volt free contact) as option
FLEX COLOUR	Grey
PRODUCT WARRANTY	15,000 cycles
DUTY CYCLE	2 mins on, 7 mins off
PROTECTION DEGREE	IP20
BRACKET	Sill fixing/ open inward/ face fix bracket
SYNCHRONISATION	Optional
APPLICATION	Smoke and Environmental Ventilation

*Care must be taken when using the 601-900mm stroke actuator in a top hung application, please contact SE Controls for further details.